



No onward chain. This two bedroom apartment is located on the ground floor of this prestigious 1930's 'Art-Deco' style mansion block. Close to the shops of Gosforth High Street and within Gosforth's Conservation Area, Moor Court is ideally located on Westfield, Gosforth.

The accommodation briefly comprises; communal entrance hallway, with secure telephone entry system and lift access to all floors; open plan lounge kitchen with dual windows providing views towards Newcastle's Town Moor, kitchen with integrated appliances and a breakfasting bar; shower room WC, part tiled with step in shower, wash hand basin and WC; two small bedrooms, similar in size. With gas central heating, double glazed windows and off street residents' parking, early viewings are advised.

1930's Mansion Block | 642 Sq. Ft (59.7 m2) | Gosforth Conservation Area | Ground Floor Apartment | Two Bedrooms | Open Plan Lounge/ Kitchen | Shower Room WC | Communal Lift Access | Residents' Off Street Parking | Telephone Entry | GCH & DG | No Onward Chain | Lease Length - 973 Years | Service Charge - £2,588 Per Annum | Council Tax Band: A | EPC Rating: D



GROUND FLOOR
652 sq.ft. (60.6 sq.m.) approx.

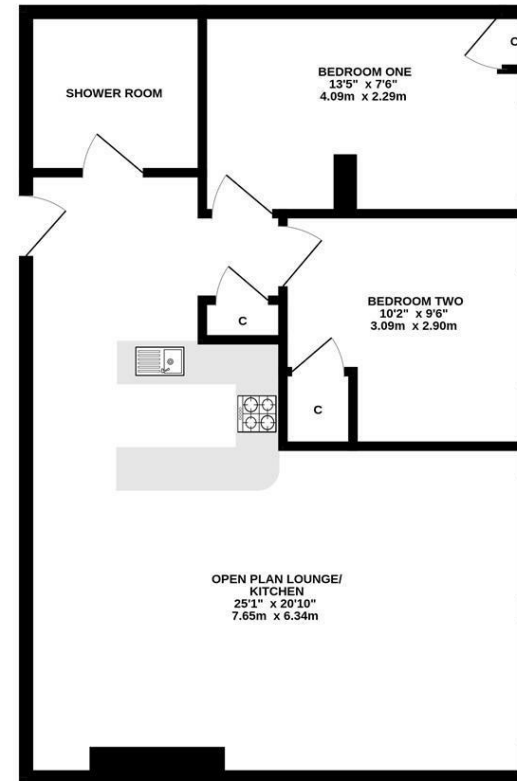

TOTAL FLOOR AREA - 652 sq.ft. (60.6 sq.m.) approx.
Whilst every attempt has been made to ensure the accuracy of the floorplan contained here, measurements of doors, windows, rooms and any other items are approximate and no responsibility is taken for any error, omission or mis-statement. This plan is for illustrative purposes only and should be used as such by any prospective purchaser. The services, systems and appliances shown have not been tested and no guarantee as to their operability or efficiency can be given.
Made with Metropix ©2026



Offers Over £175,000

IMPORTANT NOTE: These particulars and the descriptions and measurements herein do not constitute representation and whilst every effort has been made to ensure accuracy, this cannot be guaranteed.

